

**ASHFORD  
& MOULT**  
ESTATE AGENTS

**£325,000**

**Buckle Drive**

Nottingham, NG14 6JY

**ASHFORD  
& MOULT**  
ESTATE AGENTS

## PROPERTY SUMMARY

\*DORMER-BUNGALOW\*

This delightful three-bedroom dormer bungalow on Bucklee Drive offers a perfect blend of comfort and convenience, making it an ideal space for family gatherings or quiet evenings in.

The dormer bungalow boasts three well-appointed bedrooms, including a main bedroom with the added luxury of an en-suite bathroom, ensuring privacy and comfort. The family bathroom is also thoughtfully designed, catering to the needs of a modern household. The heart of the home is undoubtedly the kitchen, which is complemented by a lovely conservatory that allows natural light to flood in, creating a bright and inviting atmosphere for cooking and dining.

Additionally, the converted garage has been transformed into a third bedroom, providing flexibility for guests, a home office, or a playroom for children. Outside, there is parking available for one vehicle, adding to the practicality of this charming residence.

Situated close to local shops and with convenient bus routes to Arnold, Mapperley, and Nottingham, this bungalow is perfectly positioned for those seeking easy access to amenities and transport links. Whether you are a growing family or looking to downsize, this property offers a wonderful opportunity to enjoy a comfortable lifestyle in a friendly community. Don't miss the chance to make this lovely bungalow your new home.

3



2



1





ASHFORD  
& MOULT  
ESTATE AGENTS





ASHFORD  
& MOULT  
ESTATE AGENTS

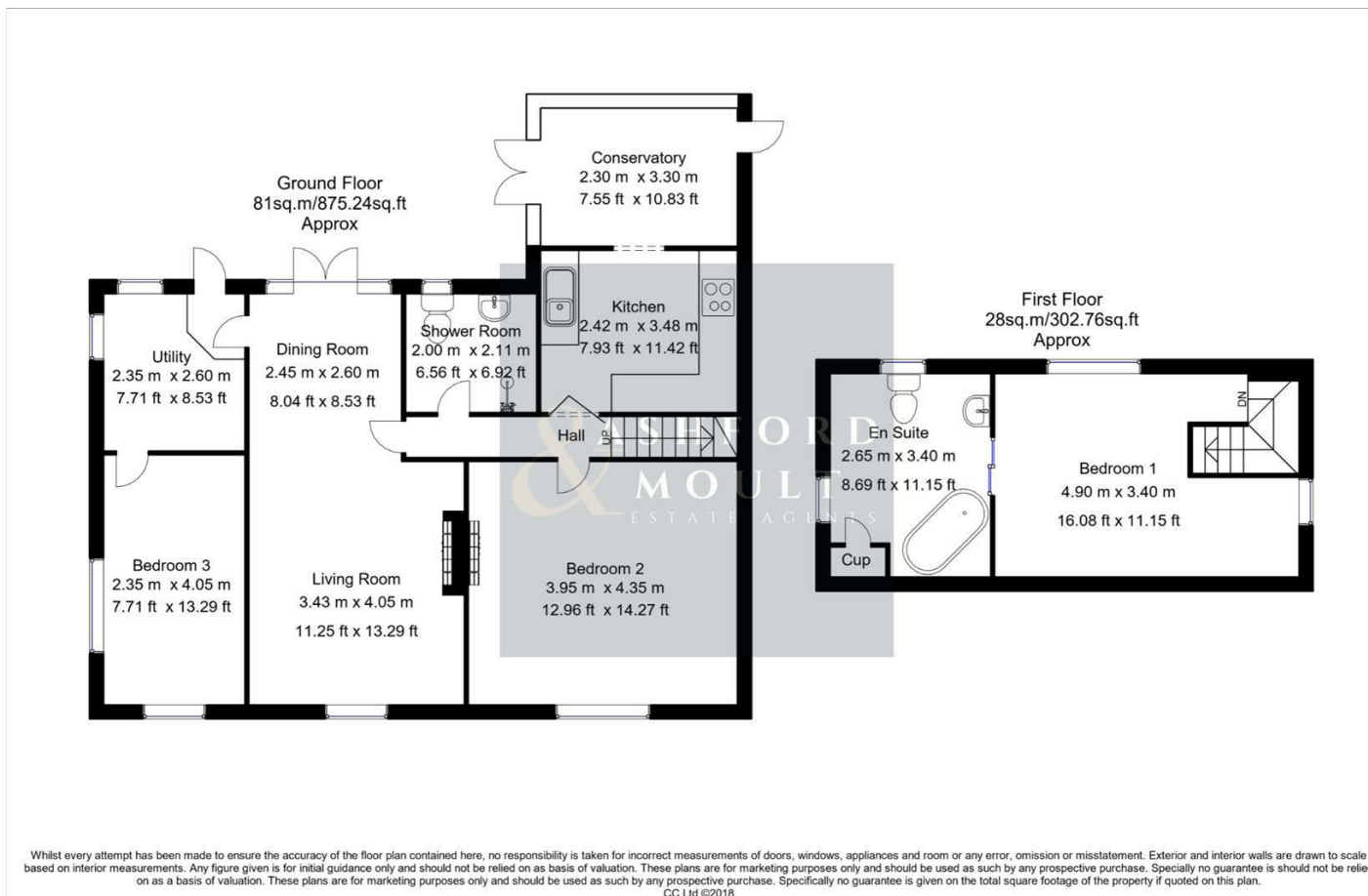

**LOCAL AUTHORITY**  
Gedling Borough Council

**TENURE**  
Freehold

**COUNCIL TAX BAND**  
C

**VIEWINGS**  
By prior appointment only

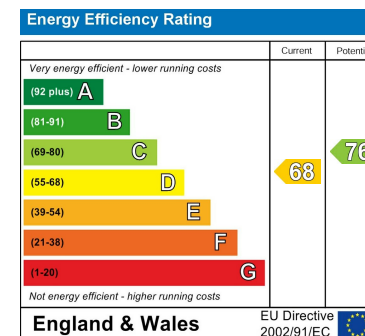

Agents Note: Whilst every care has been taken to prepare these particulars, they are for guidance purposes only. All measurements are approximate and are for general guidance purposes only and whilst every care has been taken to ensure their accuracy, they should not be relied upon and potential buyers/tenants are advised to recheck the measurements



**OFFICE ADDRESS**

56 Main Street  
Calverton  
Nottinghamshire  
NG14 6FN

**OFFICE DETAILS**

01158 656675  
sales@ashfordandmoult.co.uk